



**M & J
DEVELOPERS**

THE FARMS AT SUMMIT LAKES

AN AGRICULTURAL
CONSERVATION EASEMENT

Features:

- 8 Large Parcels Ranging from 10.1 Acres to 67.6 Acres.
- Each tract of land includes acreage protected by a conservation easement and a 3-acre building site.
- A 25+ Acre Recreation Lake w/ community beach area & dock.

CONTACT US

(336) 601-7259

(336) 587-3673

3714 Alliance Dr. Suite 300
Greensboro, NC 27407.



The Farms at Summit Lakes is a prime opportunity to build your dream home on a large scenic tract of land protected by an agricultural conservation easement.

www.mjdevelopers.com/the-farms-at-summit-lakes



THE FARMS AT SUMMIT LAKES

AN AGRICULTURAL CONSERVATION EASEMENT

COMMUNITY INFORMATION

Nestled in the peaceful countryside of Browns Summit, The Farms at Summit Lakes offers a private, secluded lifestyle without sacrificing convenience. Enjoy direct lakefront lots, expansive acreage, and access to a 25+ acre recreational lake complete with a community beach and dock.

M & J DEVELOPERS INC. & ADVANTAGE BUILD

3714 Alliance Dr. Suite 300,
Greensboro, NC 27407.

**For Illustrative Purposes Only
Not Drawn to Scale**

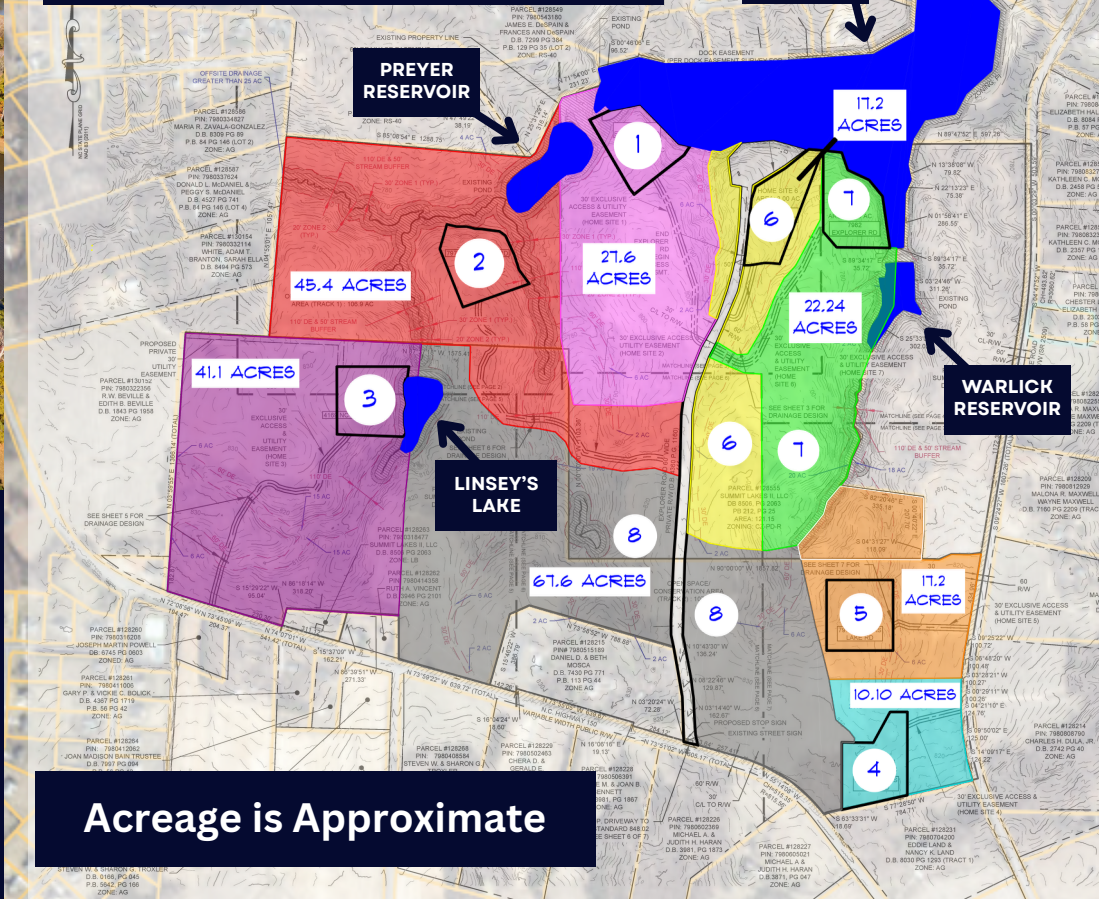

Acreage is Approximate

Lot Number	Acreage (Approx.)	Price	Price Per Acre
1	27.6 acres	\$684,000	\$24,783
2	45.4 acres	\$951,000	\$20,947
3	41.1 acres	\$821,500	\$19,988
4	10.1 acres	\$256,500	\$25,396
5	17.2 acres	\$363,000	\$21,105
6	17.2 acres	\$528,000	\$30,698
7	22.24 acres	\$603,600	\$27,140
8	67.6 acres	SOLD	SOLD

INTERESTED? CONTACT US:

(336) 601-7259
(336) 587-3673

