



COBB FARM

Features:

- 14 Lots - Many sightlines of the beautiful Lake Hunt.
- 1.0 - 2.8 Acre Lots.
- Convenient access to Greensboro, Eden, Burlington, Stokesdale, Browns Summit, Danville, VA.
- Custom Design & House Plan to fit your needs.



CONTACT US

(336) 601-7259

(336) 587-3673

3714 Alliance Dr, Suite 300,
Greensboro, NC 27407.



**M & J
DEVELOPERS**

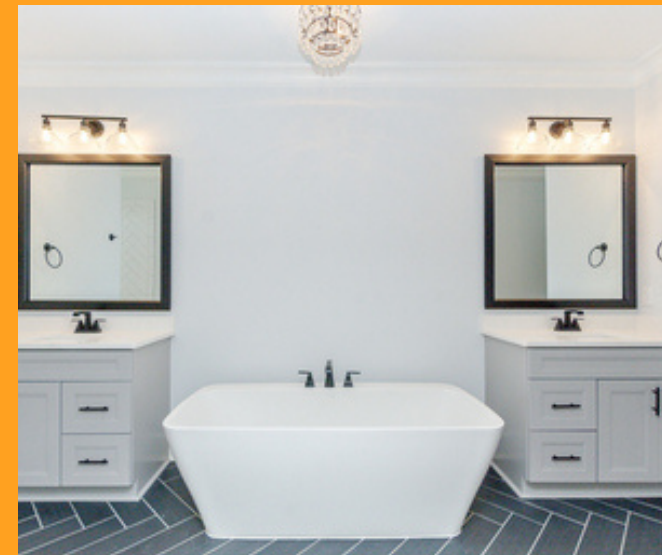

A Beautiful New
Neighborhood brought to
you by M & J Developers
and Advantage Build.

www.mjdevelopers.com/cobb-farm

For Illustrative Purposes Only.
Not Drawn to Scale.

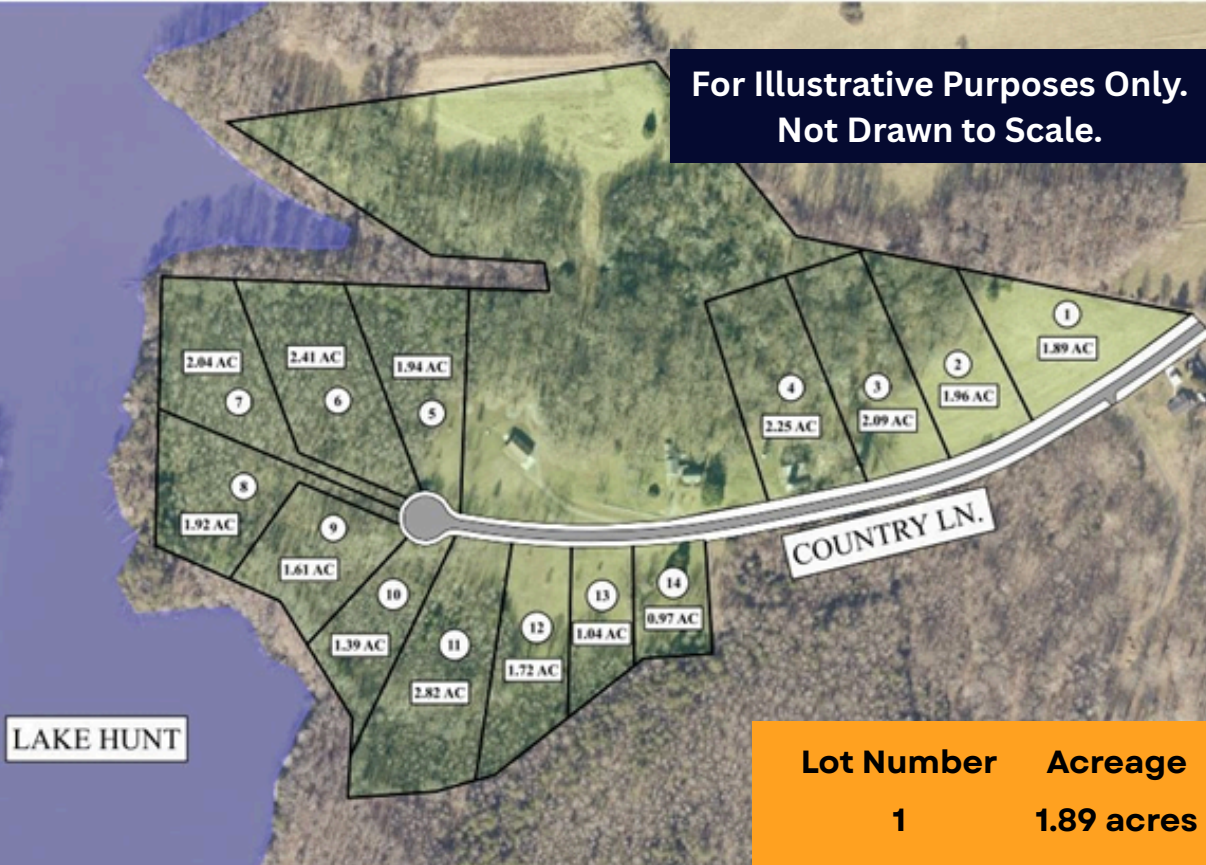

LOT INFORMATION:

INTERESTED? CONTACT US:

(336) 601-7259

(336) 587-3673

Lot Number	Acreage	Price
1	1.89 acres	Sold
2	1.96 acres	Sold
3	2.09 acres	Sold
4	2.25 acres	Sold
5	1.94 acres	Sold
6	2.41 acres	Sold
7	2.04 acres	Sold
8	1.92 acres	Sold
9	1.61 acres	Sold
10	1.39 acres	Sold
11	2.82 acres	\$120,000
12	1.72 acres	Sold
13	1.04 acres	\$85,000
14	0.97 acres	Sold

COBB FARM

COMMUNITY INFORMATION

Reidsville is a vibrant community offering some of the best outdoor recreation in the area. Check out www.riseupreidsville.com/lakes or www.riseupreidsville.com/trailsandparks for more information.

M & J DEVELOPERS INC. & ADVANTAGE BUILD

3714 Alliance Dr. Suite 300,
Greensboro, NC 27407.

